



AHD 4MP Vari-focal Eyeball Camera

Features

- 1/3" 4MP CMOS sensor
- Up to 300m coax cable transmission
- Enhancements: D-WDR, 2D NR, BLC, highlight suppression
- Multi-lingual OSD menu



Dimensions

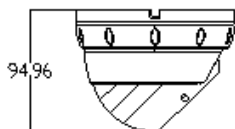
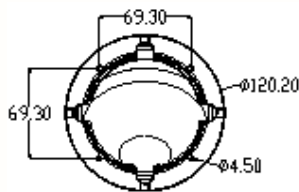

Specifications

Model	AF4-D34W
CAMERA	
Image Sensor	1/3" 4MP CMOS sensor
Effective Pixel	2688 (H) x 1520 (V)
Frame Rate	25/30fps
Video Output	1.0Vp-p composite video, 75Ω
Min. Illumination	0.0 lux (IR on)
IR Range	30m
Sync System	Internal
Scan System	Progressive scan
Lens	2.8 - 12mm
Electronic Shutter	Auto / manual (1/30 - 1/50000) / FLK
CONTROL	
Video Adjustment	Brightness, sharpness
White Balance	ATW / AWC-SET / AWB / indoor / outdoor / manual
Noise Reduction	2D NR / off
Digital WDR	Auto / on / off
Video Compensation	BLC / HLC / off
Auto Gain Control	Auto / on / off
Day / Night Mode	Auto / B/W / color
Orientation	Mirror / upside down / 180° rotation
MISCELLANEOUS	
Weather Protection	IP65
Operating Environment	-10 ~ 50°C / 90% relative humidity (no condensation)
Power Supply	DC12V, 8W
Dimensions (mm)	95 (H) x Φ120 (D)
Weight	675g
Accessories	CC-WL0D3, CC-DP0D3



WAMA Technology Limited

Unit 502, 5/F, Block B, Wing Kut Industrial Building,
608 Castle Peak Road, Kowloon, Hong Kong.

Tel : (852) 3703 9260

Fax : (852) 3705 0053

Email : info@wamatech.co

Website : www.wamatech.co